

ARS02系列

▶ 性能参数

- 环境温度：-40℃~70℃
- 额定电流：10A
- 钢制卡簧型号：ARS-H1
- 插入式模块：无
- 剥露导线长度：7mm
- 适用继电器型号：ARL系列
- 额定电压：250VAC
- 介质耐压min.：2000VAC(输入输出间)
- 标识卡：无
- 螺钉扭矩：1.0Nm
- 最大导线范围：2×1.5mm²

▶ 型号注释

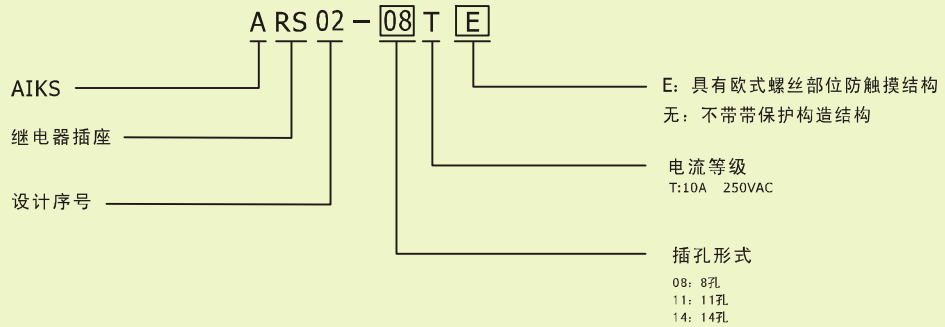

▶ 外形图, 接线图, 安装尺寸图

单位: mm

ARS02-08T

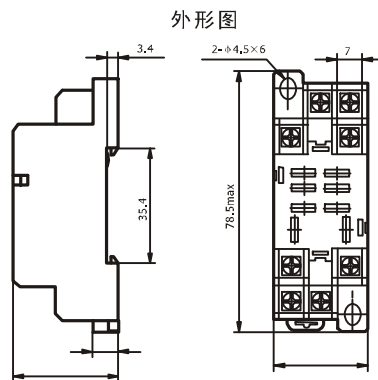

接线图

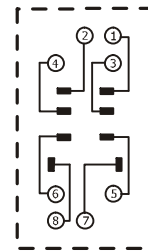

安装孔尺寸

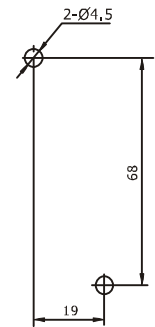

ARS02-08TE

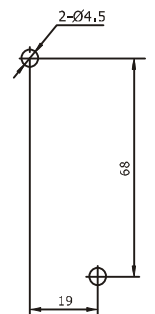
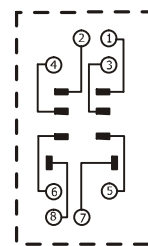
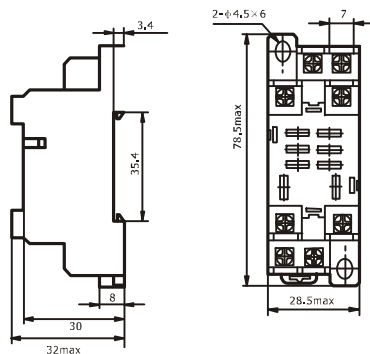

▶ 外形图, 接线图, 安装尺寸图 单位: mm

ARS02-11T

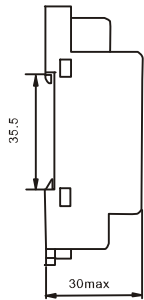

外形图

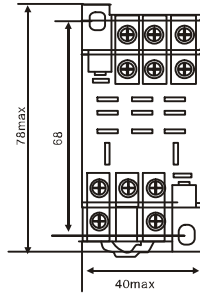

接线图

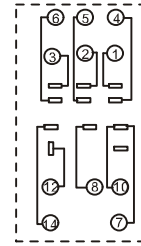

安装孔尺寸

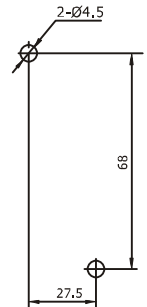

ARS02-14T

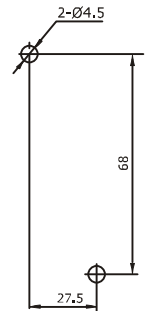
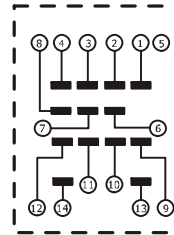
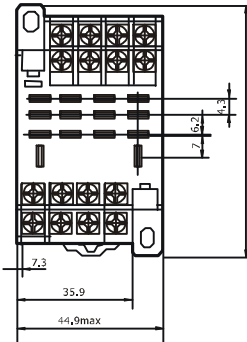
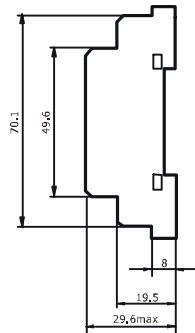

ARS02-14TE

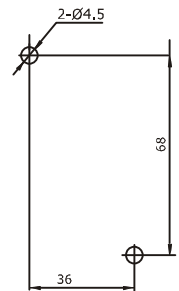
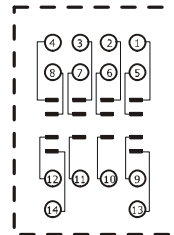
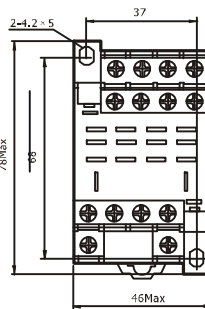
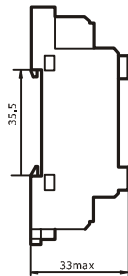

▶ 配套卡簧尺寸 单位: mm

ARS-H1

