

ARS05系列

▶ 性能参数

- 环境温度：-40℃~85℃
- 额定电流：7A、12A
- 卡簧：ARS-H5
- 插入式模块：无
- 剥露导线长度：7mm
- 适用继电器型号：ARM/L系列
- 额定电压：250VAC
- 介质耐压min.：2000VAC(输入输出间)
- 标识卡：无
- 螺钉扭矩：1.0Nm
- 最大导线范围：2×1.5mm²

▶ 型号注释

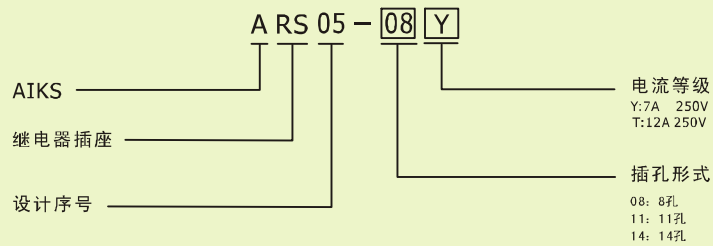

▶ 外形图, 接线图, 安装尺寸图

单位: mm

ARS05-08Y

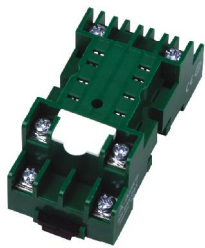

外形图

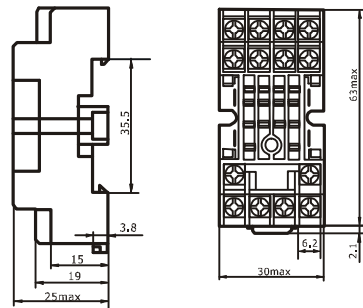

接线图

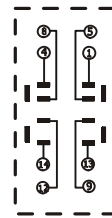

安装孔尺寸

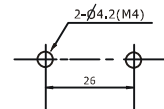

ARS05-11Y

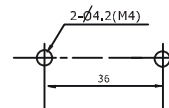
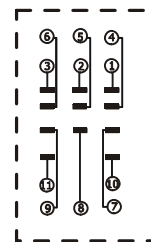
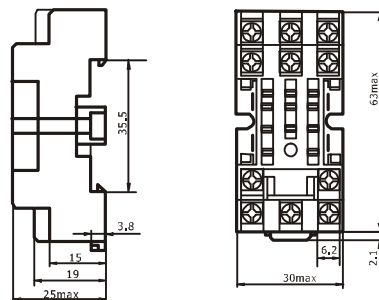

▶ 外形图, 接线图, 安装尺寸图

单位: mm

外形图

接线图

安装孔尺寸

ARS05-14Y

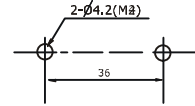
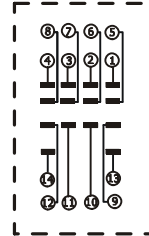
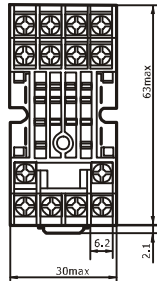
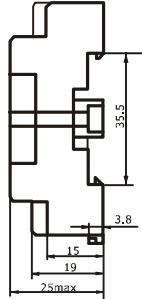

ARS05-08T

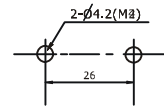
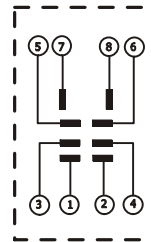
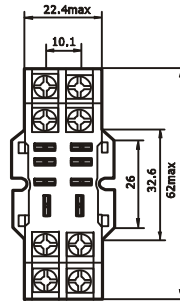
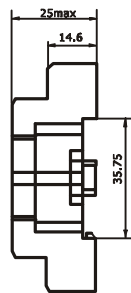

ARS05-11T

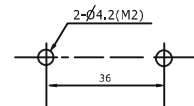
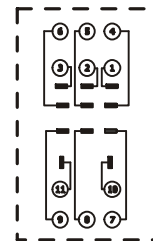
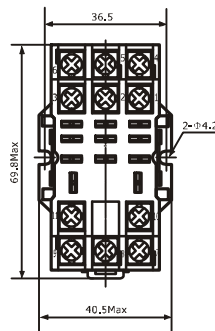
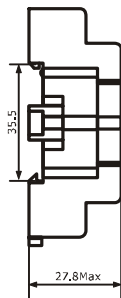

ARS05-14T

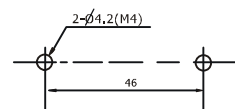
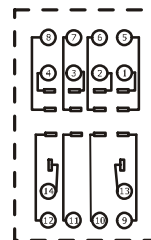
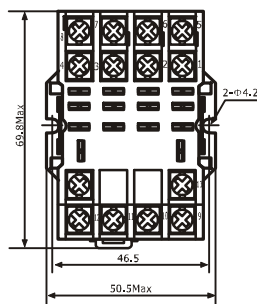
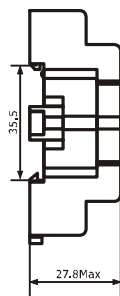

▶ 配套卡簧尺寸

单位: mm

ARS-H5

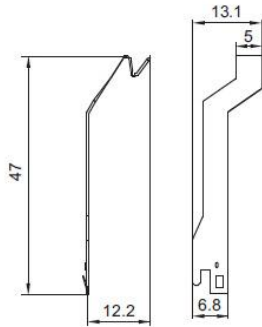

▶ 标识卡尺寸

单位: mm

